

IELTS

Actual Tests

Reading & Listening



ACADEMIC MODULE

Based on Past Papers in 2019

10 Reading Actual Tests in 2019

10 Listening Actual Tests in 2019



IELTSMATERIAL.COM

Table of Contents

LISTENING	5
TEST 1	5
SECTION 1.....	5
SECTION 2.....	6
SECTION 3.....	7
SECTION 4.....	9
TEST 2	10
SECTION 1.....	10
SECTION 2.....	10
SECTION 3.....	12
SECTION 4.....	13
TEST 3	14
SECTION 1.....	14
SECTION 2.....	15
SECTION 3.....	16
SECTION 4.....	18
TEST 4	19
SECTION 1.....	19
SECTION 2.....	20
SECTION 3.....	22
SECTION 4.....	23
TEST 5	24
SECTION 1.....	24
SECTION 2.....	25
SECTION 3.....	27
SECTION 4.....	28
TEST 6	29
SECTION 1.....	29
SECTION 2.....	30
SECTION 3.....	32
SECTION 4.....	33
Test 7	34
SECTION 1.....	34
SECTION 2.....	35
SECTION 3.....	37
SECTION 4.....	37
Test 8	39
SECTION 1.....	39
SECTION 2.....	40
SECTION 3.....	41
SECTION 4.....	42
Test 9	44
SECTION 1.....	44
SECTION 2.....	45
SECTION 3.....	46
SECTION 4.....	48
TEST 10	50
SECTION 1.....	50

IELTS ACTUAL TESTS – READING & LISTENING ACADEMIC MODULE

SECTION 2	50
SECTION 3	52
SECTION 4	54
READING	55
TEST 1	55
READING PASSAGE 1	55
READING PASSAGE 2	59
READING PASSAGE 3	63
TEST 2	66
READING PASSAGE 1	67
READING PASSAGE 2	70
READING PASSAGE 3	75
TEST 3	79
READING PASSAGE 1	79
READING PASSAGE 2	83
READING PASSAGE 3	87
TEST 4	91
READING PASSAGE 1	91
READING PASSAGE 2	95
READING PASSAGE 3	99
TEST 5	104
READING PASSAGE 1	104
READING PASSAGE 2	108
READING PASSAGE 3	112
TEST 6	117
READING PASSAGE 1	117
READING PASSAGE 2	120
READING PASSAGE 3	124
TEST 7	129
READING PASSAGE 1	129
READING PASSAGE 2	133
READING PASSAGE 3	138
TEST 8	143
READING PASSAGE 1	143
READING PASSAGE 2	147
READING PASSAGE 3	151
TEST 9	157
READING PASSAGE 1	157
READING PASSAGE 2	161
READING PASSAGE 3	166
TEST 10	171
READING PASSAGE 1	172
READING PASSAGE 2	176
READING PASSAGE 3	179
SOLUTION FOR LISTENING	185
TEST 1	185
Section 1	185
Section 2	185

IELTS ACTUAL TESTS – READING & LISTENING ACADEMIC MODULE

Section 3.....	185
Section 4.....	186
TEST 2	187
Section 1.....	187
Section 2.....	187
Section 3.....	187
Section 4.....	188
TEST 3	188
Section 1.....	188
Section 2.....	188
Section 3.....	189
Section 4.....	189
TEST 4	190
Section 1.....	190
Section 2.....	190
Section 3.....	190
Section 4.....	191
TEST 5	191
Section 1.....	191
Section 2.....	192
Section 3.....	192
Section 4.....	192
TEST 6	193
Section 1.....	193
Section 2.....	193
Section 3.....	193
Section 4.....	194
TEST 7	194
Section 1.....	194
Section 2.....	195
Section 3.....	195
Section 4.....	195
TEST 8	196
Section 1.....	196
Section 2.....	196
Section 3.....	197
Section 4.....	197
TEST 9	197
Section 1.....	197
Section 2.....	198
Section 3.....	198
Section 4.....	199
TEST 10	199
Section 1.....	199
Section 2.....	199
Section 3.....	200
Section 4.....	200
READING	201
TEST 1	201

IELTS ACTUAL TESTS – READING & LISTENING ACADEMIC MODULE

Reading Passage 1.....	201
Reading Passage 2.....	201
Reading Passage 3.....	202
TEST 2	202
Reading Passage 1.....	202
Reading Passage 2.....	203
Reading Passage 3.....	203
TEST 3	204
Reading Passage 1.....	204
Reading Passage 2.....	204
Reading Passage 3.....	204
TEST 4	205
Reading Passage 1.....	205
Reading Passage 2.....	206
Reading Passage 3.....	206
TEST 5	206
Reading Passage 5.....	207
Reading Passage 2.....	207
Reading Passage 3.....	207
TEST 6	208
Reading Passage 1.....	208
Reading Passage 2.....	208
Reading Passage 3.....	209
TEST 7	209
READING PASSAGE 1.....	209
READING PASSAGE 2.....	210
READING PASSAGE 3.....	210
TEST 8	210
READING PASSAGE 1.....	210
READING PASSAGE 2.....	211
READING PASSAGE 3.....	211
TEST 9	211
READING PASSAGE 1.....	211
READING PASSAGE 2.....	212
READING PASSAGE 3.....	212
TEST 10	212
READING PASSAGE 1.....	212
READING PASSAGE 2.....	213
READING PASSAGE 3.....	213

LISTENING

TEST 1

SECTION 1

Question 1-5

Complete the table below.

Write ONE WORD AND/OR NUMBERS for each answer.

JOB HUNTING			
Company's name	Job details	Reference number	Contact
<i>Example</i> POWER (manufacturing company)	<ul style="list-style-type: none"> work in a 1 	SW35FT	Jane 2
COTTON (grocery company)	<ul style="list-style-type: none"> good pay work <ul style="list-style-type: none"> – in 3 office – in a 4 chance of promotion 	5	go to office

Question 6 -10

Complete the notes below

Write ONE WORD ONLY for each answer.

Notes on Jobs

- Local jobs can be found in the 6.....
- Buy the 7.....to get one free magazine (Job Plus)
- Feel stress and spend a lot of time looking for jobs
- Advisable to go to an 8.....instead of the recruitment seminar
- Bring a student card (10% discount)
- Referee:
 - former boss (once had a job)
 - one of the 9.....(if not)
- Intend to take the art course

- Fill out a 10.....form at the end of the course

SECTION 2

Question 11 - 15

Choose the correct letter, A, B or C.

11 The reason why David is replacing Jane is that

- A. she is unwell.
- B. she is very busy.
- C. she is inexperienced.

12 According to the speaker, what is the problem for the museum currently?

- A. lack of staff
- B. lack of publicity
- C. lack of money

13 Why were the thieves able to successfully steal the statue?

- A. The security device is outdated.
- B. The security guard is not well-trained.
- C. They knew what they were searching for.

14 In order to improve security, they are going to

- A. get more closed-circuit television cameras.
- B. hire more security guards.
- C. buy more computers.

15 What kind of librarian are they looking for?

- A. responsible
- B. experienced
- C. highly-trained

Question 16 - 20

Label the map below.

Write the correct letter, A-H, next to questions 16-20.

City Museum

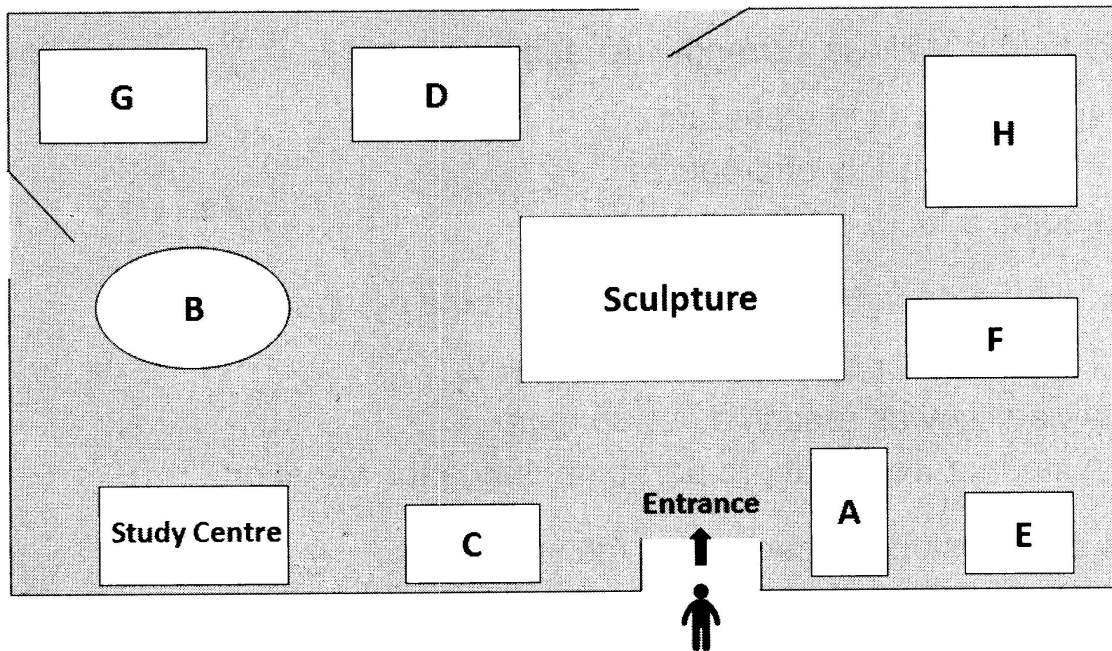

- 16 Box Office
- 17 Children's Room
- 18 Cafe
- 19 Multimedia Room
- 20 Showroom

SECTION 3

Question 21 - 26

Choose the correct letter, A, B or C.

Willows Studies

21 What field is Willows currently focused on?

- A. Specialising in one product
- B. making a variety of products
- C. adding a lot of retail outlet

22. How did the students feel about the software?

- A. The professor contacted the company.
- B. An article was read in a newspaper
- C. A student work their part-time during the vacations.

23. How did the student feel about the software

- A. It's not easy to predict.
- B. It's slow for drawing designs
- C. It had a good interface.

24 How did the students find out about the effects of the software on the company?

- A. They went to the IT department.
- B. They talked with the manager.
- C. They inspected the accounts.

25 The reason why the students have a face-to-face interview alone is that

- A. they could prepare for exams.
- B. there will be less disturbance.
- C. it's less realistic.

26 How did the two students perform in the exam?

- A. very disappointing
- B. significantly good
- C. above the average

Question 27 - 28

Choose TWO letters, A-E.

In which TWO ways will the new system affect the company?

- A. gain more profit
- B. employ more new staff
- C. increase sales
- D. reduce production time
- E. cut labour costs

Questions 29 and 30

Choose TWO letters, A

Which TWO effects will the new system have on new clients?

- A. getting more involved in the design
- B. obtaining more contacts

- C. linking at home to do online work
- D. wasting less time
- E. decreasing labour costs

SECTION 4

Complete the notes below.

Write ONE WORD ONLY for each answer.

A Survey Research

Results of Questionnaire

- The patients preferred to choose the hospital because of the free 31..... service provided.
- Most patients wished the hospital to be 32.....
- Patients were concerned about prior 33.....about the hospital treatment.

Actions in the next year

- improvements on website for local 34.....as well as hospital medical staff
- incentive to motivate the members of staff
- extra 35.....for staff's success in work
- considering the opinions of the 36
- improving the effectiveness of 37.....between patients, doctors and staff
- first-come-first-served system

Recommendation

- A new unit would be built for those who are suffering from 38..... disturbance.
- A new ward would be proposed to those in need of 39..... surgery.
- The equipment is advanced enough to do with the treatments.
- More effective 40.....is needed to improve the efficiency of communication.

TEST 2

SECTION 1

Complete the table below.

Write ONE WORD AND/OR A NUMBER for each answer.

Notes on A Part-time Society

Example

Name of society: Leighton

Location: 1.....house

Want: 2.....actors and singers (no experience required)

Transportation: shuttle services (need someone who is able to 3.....)

Meeting time: 6:00-8:00pm
every 4.....

Close time: during 5.....

Membership fee (including 6.....)

- £40 for employed members (under 30 years of age)

- £ 60 for employed members (30-60 years of age)

- £ 7 for retired or unemployed members (over 60 years of age)

Minimum joining age

- 8.....

Most members are

- friendly

- fond of culture and music

- 9.....authors looking for new experiences to write about in their books

Charity

The children's 10.....will get the money raised by the annual dinner.

SECTION 2

Questions 11-14

Choose the correct letter, A, B or C.

11 What kind of changes is the station making?

- A. relocation
- B. reconstruction
- C. expansion

12 The original buildings on the site were

- A. houses.
- B. industrial buildings.
- C. shops.

13 Firstly the station intended to use the site as

- A. a leisure centre.
- B. a car park.
- C. a lounge.

14 The new buildings will be situated to the right side of

- A. the shopping district.
- B. the apartment blocks.
- C. the new formal gardens.

Question 15- 20

Label the map below.

Write the correct letter, A-G, next to questions 15-20.

Leisure Complex Plan

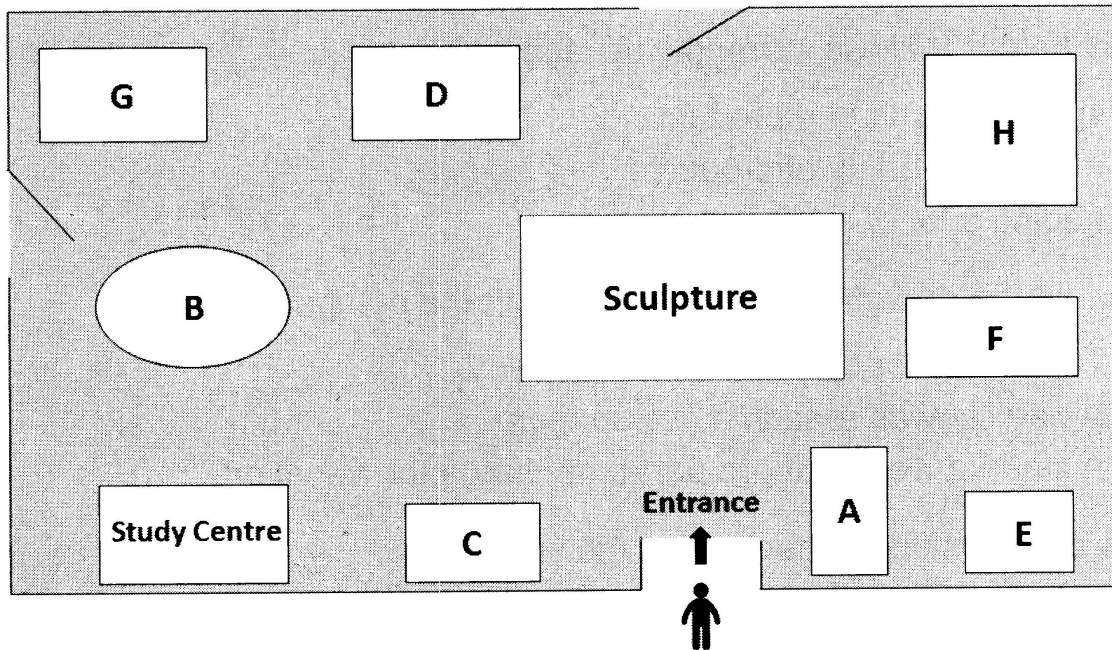

- 15 Cafe
- 16 Taxi Rank
- 17 CarPark
- 18 Passenger Waiting Area
- 19 Waiting Area for Wheelchair Users
- 20 Tourist Office

SECTION 3

Questions 21-25

Choose the correct letter, A, B or C.

- 21 What has Irene recently done?
- A. She has almost finished planning the experiment.
 - B. She is not applying herself enough to her work.
 - C. She spends a lot of time in the laboratory.
- 22 What is Bill's attitude toward Kim?
- A. He is grateful for Kim's contribution.
 - B. He is not fond of Kim's tastes in clothes.
 - C. He thinks Kim is not good at laboratory work.
- 23 What does Jen think of the other people in the group?

- A. The boys are good at maths which is very helpful.
- B. They would fail the experiment without Irene’s contribution.
- C. Irene has completed the data analysis so the experiment is nearly done.

24 How did Jen and Bill feel about Linda?

- A. She was always submitted her work late for the group work.
- B. She was difficult to get in touch with.
- C. She thought it was easy to get a high score.

25 Why was Jen invited to the professor’s individual project?

- A. She was quite popular among students.
- B. She always finished reading all the assignments.
- C. She was close to the professor.

Question 26- 30

What task has been given to each person?

Choose FIVE answers from the box and write the correct letter, A-G, next to questions 26-30.

Tasks

- A. Abstract
- B. Acknowledgement
- C. Methodology
- D. Bibliography
- E. Literature review
- F. Results
- G. Discussion

Person

- 26 Irene
- 27 Kim
- 28 Jen
- 29 Bill
- 30 Linda

SECTION 4

Complete the notes below.

Write ONE WORD ONLY for each answer.

Nanotechnology

General information

explanation: manipulation of matter on a minutes scale

huge investment in research

The reason why development of Nanotechnology may be started because of a new type of 31.....

Application

a) daily lives

- aids in getting 32..... from diet
- reduces the cost of 33.....
- improves the 34..... of food

b) agriculture

- use of Nanotechnology has resulted in a spray which increase the efficiency of 35..... in the soil and can be use instead of Artificial chemical

c) medical area

- Nanotechnology can help avoid food poisoning
- Nanotechnology can kill foods' 36.....and make them safe to eat.
- Nanoparticles are injected into the body and allow 37.....to enter the veins.
- Some certain nanoparticles are able to sterilise more than 650 types of bacteria.
- 38.....has the greatest antibacterial qualities.
- Splifferenes help 39 loss programmes.

d) cosmetics

- Preventing 40.....from entering the body avoids skin cancer.

TEST 3

SECTION 1

Complete the notes below.

Write NO MORE THAN TWO WORDS AND/OR A NUMBER for each answer.

Job Enquiry

Example

- name: Freddie Lea
- location: 1.....Island
- Starting date: 2.....
- Age: 17
- Four vacancies for 3.....
- Pay: 5.52 per hour
- Qualities required: ability to 4.....
- Duties:
 - + Offer table service
 - + Look after 5.....
- Extra advantage: ability of the candidate to 6.....

- Benefits:
 - + free 7.....
 - + a 8..... will be provided

- Interview arranged for: 9.....at 10:00 am

- Need to take
 - + a reference letter from employer
 - + a bank statement
 - + the application form with a 10.....

SECTION 2

Question 11 - 12

Choose TWO letters, A-E.

Which TWO things are included in the price of the tour?

- A. garden gloves
- B. ladybugs
- C. bush timbering lessons
- D. food
- E. hummingbirds

Questions 13 and 14

Choose TWO letters, A-E.

Which TWO facilities of Pine Garden are open today?

- A. plant care centre
- B. cafe
- C. gift shop
- D. model town
- E. tourist office

Questions 15-20

Choose SIX answers from the box and write the correct letter, A-H, next to questions 15-20.

- A. varieties of desert
- B. edible plants
- C. lawns and lawn alternatives
- D. native plants
- E. storing water
- F. plants attract wildlife
- G. unified design
- H. soil nutrients

- 15 Mary
- 16 Berson
- 17 Smith
- 18 Nunee
- 19 Scanlan
- 20 Mandelson

SECTION 3

Question 21 - 26

Choose the correct letter, A, B or C.

21 How could ancient Africans recognize different stars?

- A. by the location of the stars
- B. by the way stars affect each other

C. by the distance between two stars

22 In which way do the Weyaka people like to deal with their money?

- A. open bank accounts
- B. assist others
- C. lend money to others

23 What do the Africans obtain from their suffering?

- A. ways of protecting their environment
- B. approaches to improving their international status
- C. reasons of conquering drought

24 What are the local people concerned with?

- A. having enough food
- B. getting rid of disease
- C. going back to their former environment

25 What is the reason for the declining financial condition of the African people?

- A. They find it hard to trade because of the undeveloped transportation system.
- B. They have difficulty in mining minerals.
- C. They refuse to develop a range of commercial activities.

26 When can the African people expect to stop suffering from starvation?

- A. next year
- B. in the long-term future
- C. in the near future

Question 27 - 30

Complete the sentences below.

Write NO MORE THAN TWO WORDS for each answer.

27 A valuable quality of the Africans is to make up for the difficulties of food transportation.

28 The government intends to pay greater attention to their plan.

29 Nowadays, the Africans are encouraged to in an area consistently.

30 For the Weyaka people, it is impolite to visit someone's home without

SECTION 4

Complete the notes below.

Write NO MORE THAN TWO WORDS for each answer.

Animal Sense

Smell

- Dogs have a greater sense of smell than human beings and are able to tell.
- Some animals can smell odours such as 31.....recognised by the human nose.
- Some beetles can only distinguish the odours of certain plants.
- Bees, feeling threatened, will use their 32.....before they sting.
- Queen bees, which can sting multiple times, use their feet to keep 33.....over the colony.
- A female 34.....decides whether or not to mate with a male according to the quality of his scent.

Hearing

- Sound through vibrations can be recognized by beetles without ears by using their 35.....
- They can locate prey living in 36.....by tracking the vibrations.

Sight

- Snakes are able to search for food by detecting 37.....from the mouths of their prey.
- They can tell the 38.....of a mouse by detecting its heat.
- After its prey is killed, a snake stores food in its 39.....and hibernates.
- A snake that goes into a state of hibernation will not eat for a long period of time.
- The 40.....is calculated by snakes before hunting their prey.